



Floor plans



Rooms 1-5

Room Capacities

Room	Theatre	U-shape	B'room	Cabaret	C'room
1	100	34	40	42	60
2	80	30	36	36	50
3	30	16	22	20	24
4	90	30	36	36	50
5	90	30	36	36	50

Six syndicate rooms are also available. Each room comfortably seats 8-10 in a boardroom layout.

Rooms 6-10

Room Capacities

Room	Theatre	U-shape	B'room	Cabaret	C'room
6	30	14	20	18	20
7	40	22	26	24	30
8	30	14	20	18	20
9	40	22	26	18	30
10	100	34	40	42	60

Two syndicate rooms are also available. Each room comfortably seats 8-10 in a boardroom layout.

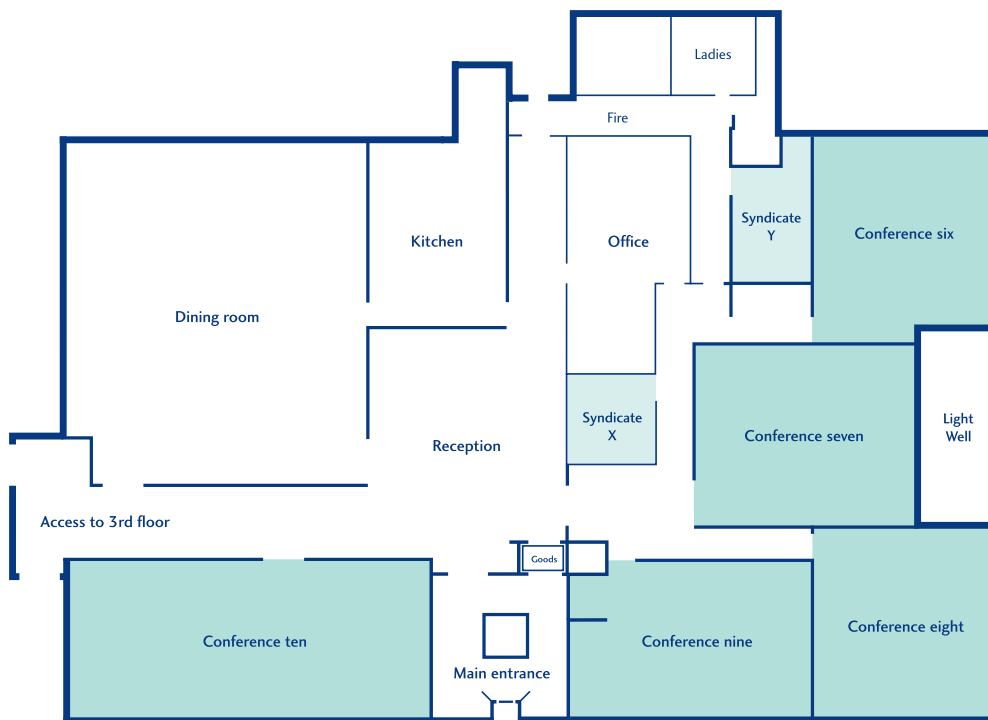

Rooms 11-12

Room Capacities

Room	Theatre	U-shape	B'room	Cabaret	C'room
11	80	30	36	36	50
12	80	30	36	36	50

